

A BUILDING
THE SYMPOSIUM RESTAURANT
THE LOCAL BAR

B BUILDING
ROOMS : 101-104 /201-204

C BUILDING
ROOMS 101-118 /201-218

D BUILDING
ROOMS :01-08/101-116/201-216

E BUILDING
ROOMS 101-106/201-206

E/W BUILDING
ROOMS 107-118/207-218
FITNESS & WELLNESS AREA

E BUILDING
ROOMS 119-123/219-223

F BUILDING
ROOMS 101-104/201-204

G BUILDING
ROOMS 101-106/201-206

K BUILDING
KUKUNARI RESTAURANT

M
MAIN POOL

N
POOL B-C-D ROOMS
Please note that The pool between buildings B-C-D can be used by the guests who are fading and staying by the pool and specially for the rooms : B101- B104/ B201-B204/C101- C106 /C201- C206/D101-D108/ D201-D208

O BUILDING
OPEN KIDS CLUB

R BUILDING
RECEPTION

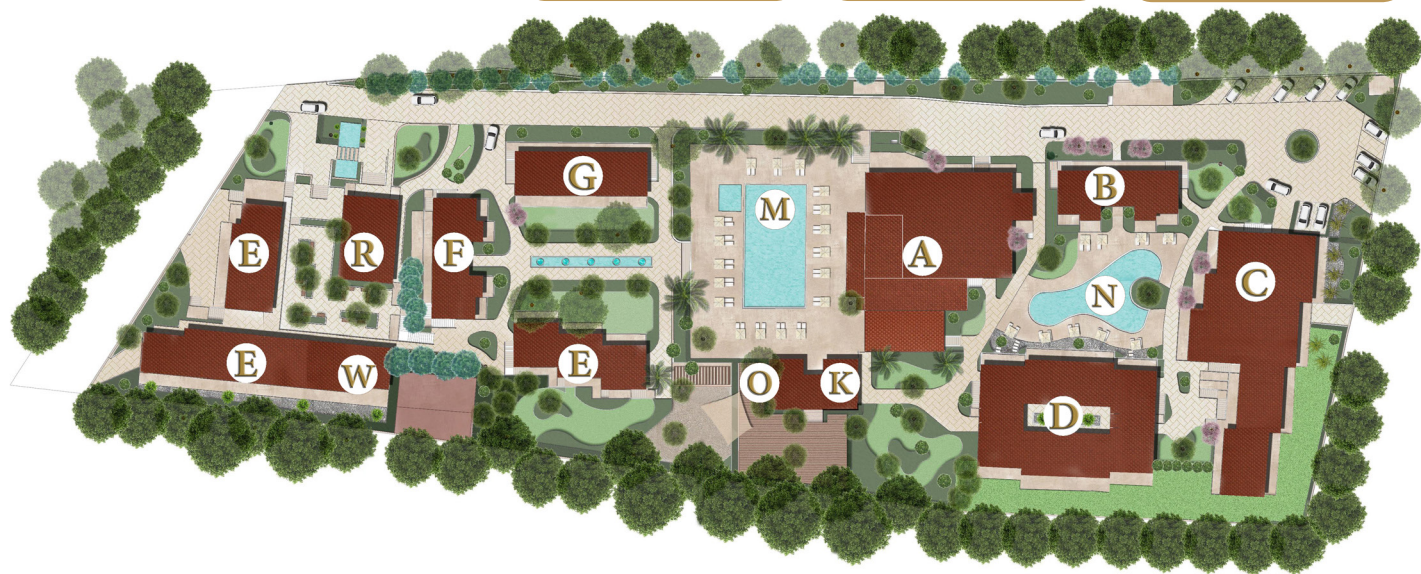



A few words.....

Philoxenia complex is situated at the begging point of Sithonia peninsula and in the settlement of Psakoudia. Just one hour of Thessaloniki, inside to a pine tree forest and just 500 meter from the sea, a modern renovated design complex offers you the ideal choice for calm holidays with quick excursions to nearby locations.

At Philoxenia Hotel 4* you will find a great, warm hug for you and your family or friends. The spacious, functional and elegance of the rooms are ideal for accommodating families and providing them absolute comfort and all necessary facilities for an unforgettable stay with view to our renewed gardens and our new swimming-pool. In its lush gardens, the heated swimming-pools, the wellness area and the beach, you can relax, work out or swim any time of the season. The wellness area is composed with a sauna, steam room and a gym area (not included, reservation is required). Kids can safely enjoy playing and diving in the children's pool. Our open area kids club is operating 6 days per week for children from 4y.o. until 12y.o.

DINING AND BAR



The Symposion' Restaurant

All meals are served at the bright, stylish and pleasant main restaurant, right in the middle of the Philoxenia Hotel complex. Here you can taste delicious Greek and international specialties, from the rich buffets.

Philoxenia offers the option of Half Board, which consists of breakfast and dinner, Full Board which consists of breakfast, lunch and dinner or the option of all-inclusive with supplement.

All Inclusive consists of breakfast, Lunch and Dinner each in a buffet form (1 dinner per week can be exchanged with 1 dinner at a la carte restaurant, reservation is required). Soft drinks, water, juices, house wine per glass and beer are served for lunch and dinner. A snack buffet is available in the morning and in the afternoon (11:00-13:00 / 15:30-17:30). Drinks with alcohol and non-alcoholic are included at the pool bar of Philoxenia from 10:00am-01:00am. With the all inclusive option, the mini-fridge in the room is filled daily with a small bottle of water per person, there is a free Wi-Fi in room, and free use of wellness area.

Opening hours daily: 07:00-10:30 / 13:00-15:00 / 18:30-21:00



Kukunari' a la carte /set menu Restaurant

A hidden restaurant in the lush garden next to the pool area. Our new à la carte restaurant, with a breathtaking view to the pine forest that surrounds the hotel, offers Greek, Mediterranean and Italian cuisine

Opening hours: 21:00-00:00 –(23:30 last order- Reservation required)

'The local' Bar- next to the pool where memories live forever



Are you up for a little variety, fun and calm? The local poolside bar says good morning and offers a great selection of light bites, ice creams and salads, drinks fresh juices and dazzling cocktails. So, lighten up, dive, Savor and relax!

Opening hours 10:00 -01:00

FUN AND WELLNESS

Kids Club/Animation team:



A recreation area for children from 4 to 12 years old. The area will operate during the daytime and there will be many weekly and daily scheduled activities from our animation team for children and for adults.

Facilities

Medical assistance (at extra charge) Small tables and chairs

High standard equipment playground

Babysitting upon request, at extra charge

Outdoor heated Swimming's Pools



Open Time Main outdoor heated pool : 10:00-19:00 every day

Open Time B-C-D outdoor heated pool: 10:00-19:00 every day.

Please note that The pool between buildings B-C-D can be used by the guests who are facing and staying by the pool and specially for the rooms : B101- B104/ B201-B204/C101-C106 /C201-C206/ D101-D108/D201-D208.

Wellness Area & Gym



The wellness and fitness center area is spread in 100 sqm of the hotel. At your disposal are a fitness studio with the most modern and new equipments, a sauna, steam room and a shower experience room .

Opening hours daily: 10:00-19:00 –(Reservation required for the use of the sauna and the steam room and is at an extra charge)

Monday to Saturday

Kindly notice though that hotel reserves the right to change the schedule of facilities' operation according to weather and occupancy conditions.



OFFICIAL PARTNER

GPS CODE: 40.267186, 23.378594

Kalives Beach Halkidiki 10km

**20% DISCOUNT
for Philoxenia Guests**